

Schnitt_Dachboden
1:100

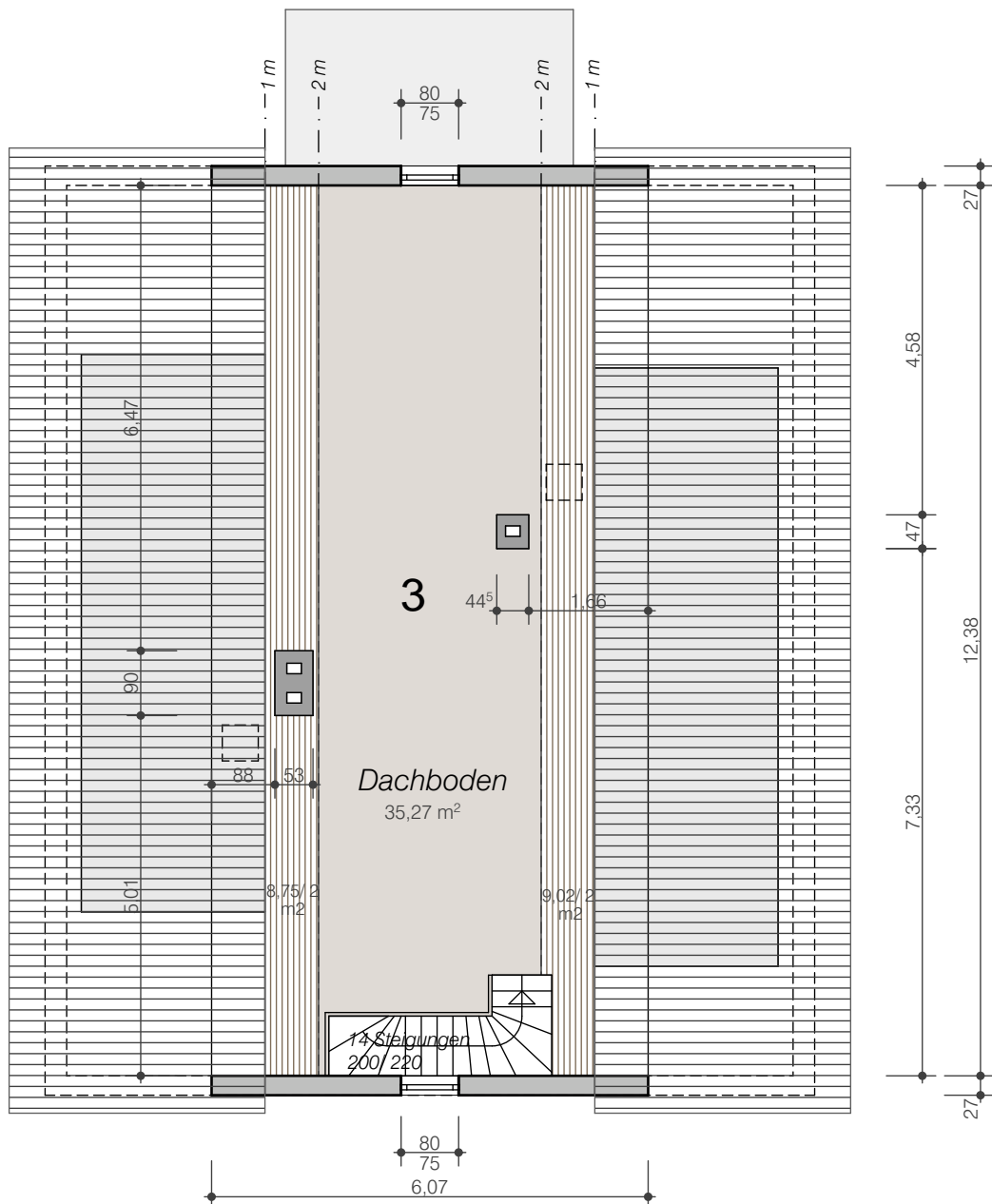
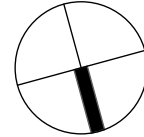

Flächenberechnung:
 $35,27 \text{ m}^2 + 8,75/2 \text{ m}^2 + 9,02/2 \text{ m}^2$
 $= 44,15 \text{ m}^2$

Grundriss_Dachboden
 Jahnstrasse 1, 99817 Eisenach
 M 1:100